

# Grating Load Tables

## PERF-O GRIP™ — 13-Hole Plank — 24" Width

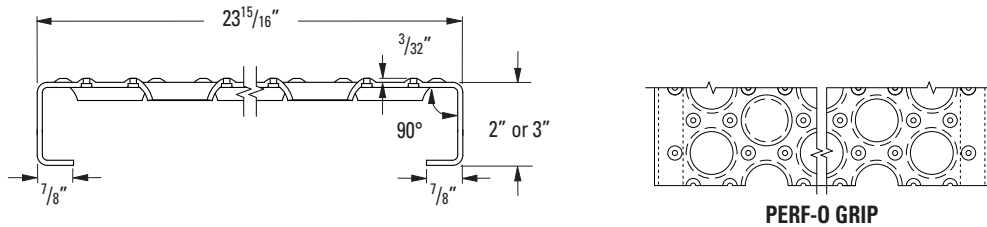

### Plank Selection/Design Tables

Allowable Loads and Deflections: U=Uniform Load (lb./ft.<sup>2</sup>) C= Concentrated Load (lb.) D=Deflection (in.)

Material Gauge	Channel Depth in. (mm)	Weight lb./lin. ft. (kg/m)	Catalog Number	Span																	
				2'-0"	2'-6"	3'-0"	3'-6"	4'-0"	4'-6"	5'-0"	5'-6"	6'-0"	6'-6"	7'-0"	7'-6"	8'-0"	9'-0"	10'-0"	11'-0"	12'-0"	
Steel 11 ga.	2" (50.8)	8.9 (13.2)	P132011	U	1094	700	486	357	273	216	175	145	123	105	91	79	70	56	45	38	33
				D	.03	.05	.06	.09	.12	.15	.18	.22	.26	.31	.36	.41	.47	.60	.75	.92	1.13
				C	2092	1674	1395	1196	1046	930	837	761	697	644	598	558	540	504	459	423	393
				D	.02	.03	.05	.06	.09	.11	.14	.17	.20	.23	.27	.31	.37	.49	.61	.74	.90
	3" (76.2)	9.8 (14.5)	P133011	U	1971	1261	876	644	493	389	315	261	219	187	161	141	124	99	80	67	57
				D	.02	.03	.04	.06	.08	.10	.12	.15	.18	.21	.24	.28	.32	.40	.50	.61	.73
				C	3792	3033	2528	2167	1896	1685	1517	1379	1264	1167	1083	1011	948	843	758	689	632
				D	.01	.02	.03	.04	.05	.07	.09	.10	.12	.15	.17	.19	.22	.30	.38	.46	.54

**PERF-O GRIP:** To order standard PERF-O GRIP grating use part number "Pxxxx".  
Standard lengths are 10'-0" and 12'-0".