

Grating Load Tables

PERF-O GRIP™ — 2-Hole Plank — 5" Width

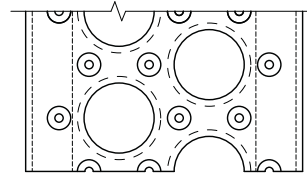

PERF-O GRIP

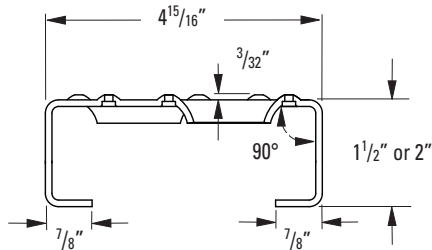
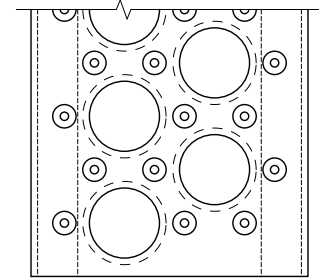

PERF-O GRIP 2

Plank Selection/Design Tables

Allowable Loads and Deflections: U=Uniform Load (lb./ft.²) C= Concentrated Load (lb.) D=Deflection (in.)

Material Gauge	Channel Depth in. (mm)	Weight lb./lin. ft. (kg/m)	Catalog Number	Span																	
				2'-0"	2'-6"	3'-0"	3'-6"	4'-0"	4'-6"	5'-0"	5'-6"	6'-0"	6'-6"	7'-0"	7'-6"	8'-0"	9'-0"	10'-0"	11'-0"	12'-0"	
Steel 13 ga.	1 1/2" (38.1)	2.6 (3.8)	P21513*	U	2008	1287	895	659	505	400	325	269	227	194	168	146	130	103	85	70	60
				D	.05	.08	.11	.15	.20	.25	.31	.38	.45	.53	.62	.71	.82	1.04	1.30	1.57	1.90
	A21513	C	836	670	559	481	421	375	338	308	284	263	244	229	216	194	176	162	150		
		D	.04	.06	.09	.12	.16	.20	.25	.30	.35	.43	.49	.57	.65	.83	1.04	1.27	1.52		
	P22013*	2" (50.8)	2.8 (4.1)	U	3035	1944	1352	994	762	603	490	405	341	292	253	221	194	155	126	105	89
				D	.04	.06	.09	.12	.15	.19	.24	.29	.34	.41	.47	.54	.62	.79	.98	1.20	1.43
A22013	C	1228	1003	845	725	635	566	510	465	427	395	368	344	324	290	263	240	223			
																			D	.03	.05
Alum. 0.125"	2" (50.8)	1.3 (1.9)	P220125*	U	2910	1863	1294	950	728	575	466	385	323	276	237	207	182	143	116	96	81
				D	.08	.12	.18	.24	.32	.40	.50	.60	.72	.84	.98	1.12	1.27	1.61	1.99	2.41	2.87
	A220125	C	1213	970	809	693	606	539	485	441	404	373	346	323	303	270	243	221	202		
		D	.06	.10	.14	.20	.25	.32	.40	.48	.57	.67	.78	.90	1.02	1.29	1.60	1.93	2.29		
	P22016S*	2" (50.8)	2.1 (3.1)	U	2781	2049	1422	1046	800	632	512	424	355	303	262	227	200	159	128	106	89
				D	.05	.08	.12	.16	.21	.26	.32	.39	.46	.54	.63	.72	.82	1.04	1.28	1.56	1.85
A22016S	C	1334	1066	889	761	666	593	534	485	445	410	381	355	334	296	267	243	223			
																			D	.04	.06

* PERF-O GRIP: To order standard PERF-O GRIP grating use part number "Pxxxxx".

PERF-O GRIP 2: To order New PERF-O GRIP 2 grating use part number "Axxxxx". End margins are standard on new PERF-O GRIP 2 grating 2-Hole through 6-Hole plank only (5" through 12" widths). Standard lengths are 10'-0" and 12'-0".